

FORM NO. 1.

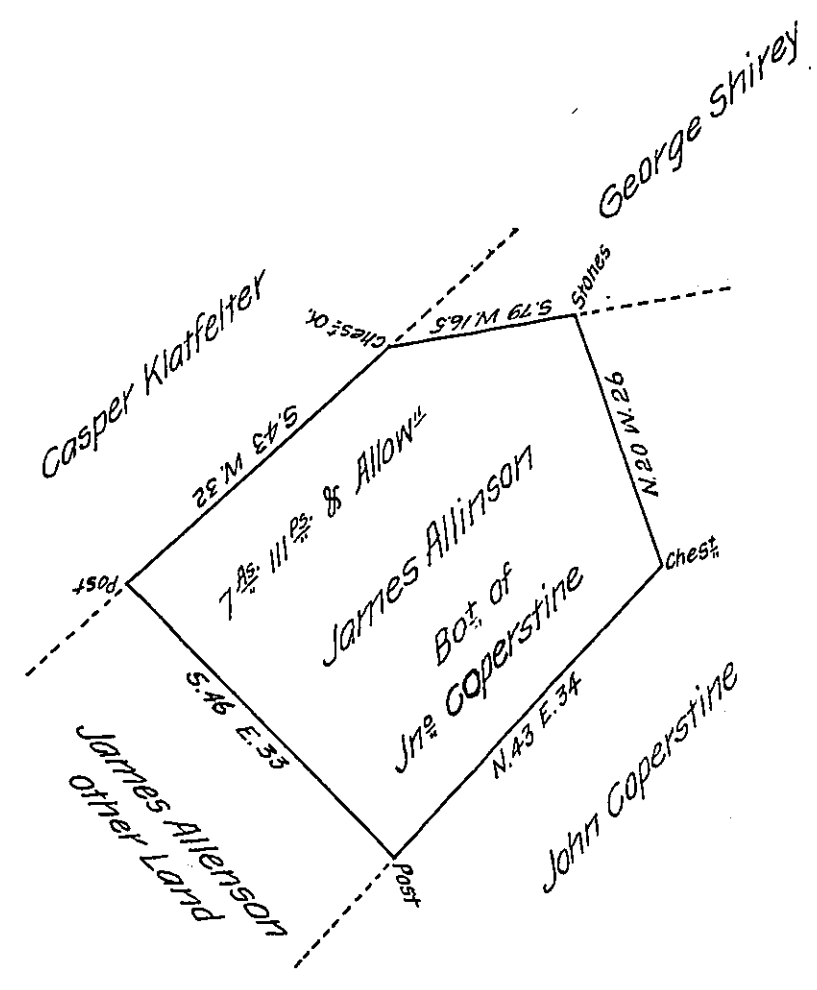

A Draught of a Tract of Land situate in Shrewsbury Township in the County of York Surveyed & Devided off from a Larger Tract Belonging to a Certain John Caperstine & at his request Surveyed of to a Certain James Allison the 7<sup>th</sup> day of September 1803 Containing as above set forth seven Acres & one hundred & eleven Perches & Allowance of Six Per Cent for Road & high ways &c.

Per Jm<sup>e</sup> Eichelberger, D.S.

W<sup>t</sup> to James Allison

dated 18<sup>th</sup> Aug. 1803

3<sup>rd</sup> No 123

I approve of the above Survey October 28<sup>th</sup> 1864.

Benj<sup>e</sup> Leese, D. S.

IN TESTIMONY that the above is a copy of the original remaining on file in the Department of Internal Affairs of Pennsylvania, made comformably to an Act of Assembly approved the 16th day of February 1833, I have hereunto set my hand and caused the Seal of said Department to be affixed at Harrisburg, this fifth day of October, 1907.

*Henry Honck*  
Secretary of Internal Affairs.